

**A300 PUMP (9806)
A750 PUMP (9821)
A750TE PUMP (9822)**

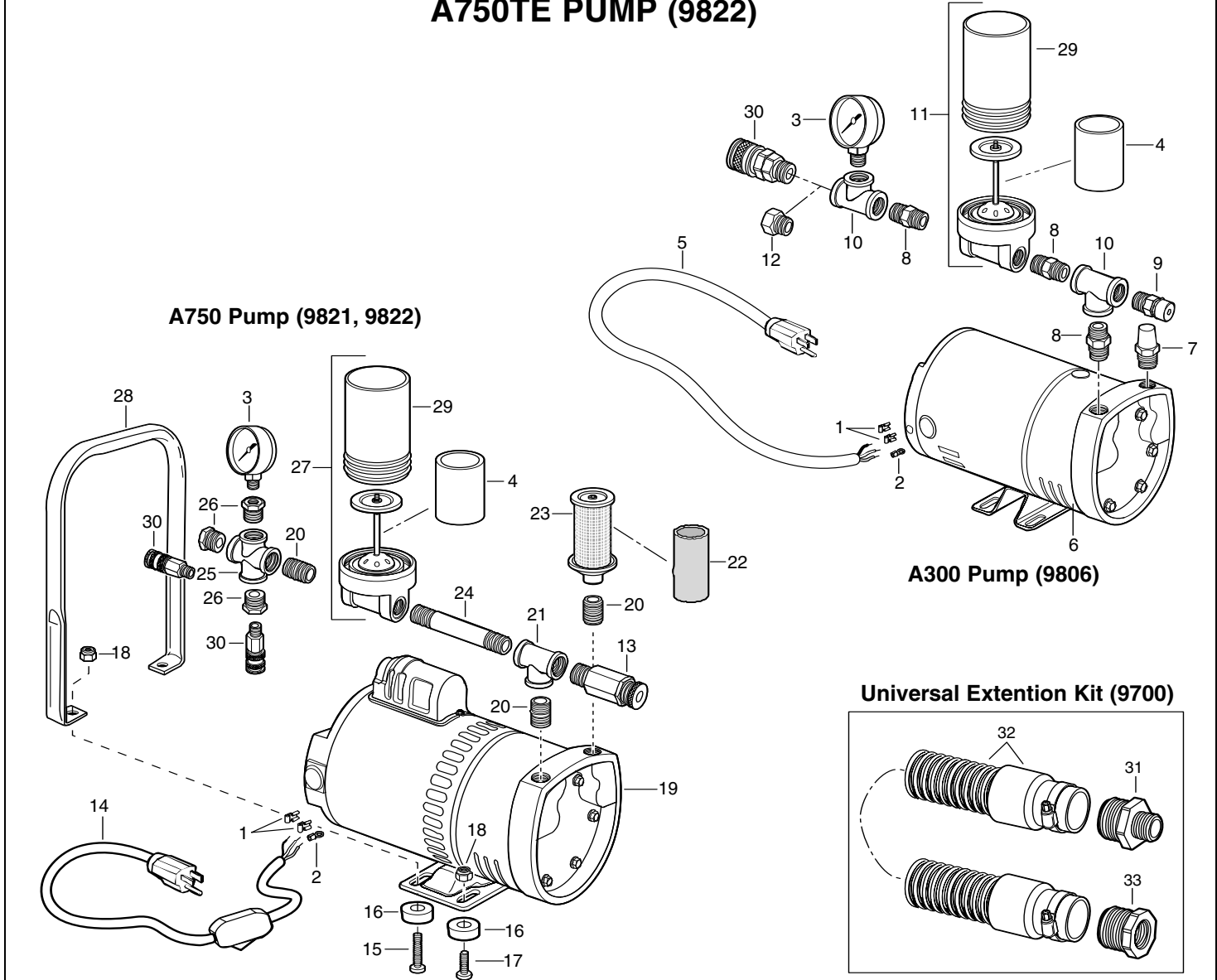

Key Part #	Description	Key Part #	Description	Key Part #	Description
9806	A-300 Pump	15	9800-68 Machine Screw	Available for Both Models	
9821	A-750 Pump	16	9700-06 Rubber Feet (each)	31	9700-60B Reducer
9822	A-750TE (Totally Enclosed)	17	9800-69 Machine Screw	32	9700-66 Universal Inlet Hose (50 Feet) w/Cuff
1	9800-75 Flag Connector	18	9800-64 Nylon Lock Nut	33	9700-60A Bushing
2	9800-76 Ground Connector	19	9821-AA Pump & Motor Assembly (3/4 HP Motor)	9700-11	Pump Flushing Liquid (Not Shown)
3	9700-04 Pressure Gauge	20	9000-05 Close Nipple Tube	9700-60C	Bushing for 9846-27 (Not Shown)
4	9700-02 Exhaust Filter Element	21	9000-04 Brass Tee	9700-27	Adaptor for 9806 (Not Shown)
5	9512-02A Cord 6.5	22	9700-01 Inlet Filter Element	Model A-300 Service Kit (Not Shown)	
6	9806AA Pump & Motor Assembly (1/4 HP Motor)	23	9700-08 Inlet Filter Assembly (w/Filter)	9700-40	Service Kit Includes; Vanes (set of 4), Filters, and Flushing Liquid
7	9700-07 Inlet Filter	24	9000-06 Nipple Tube	9700-41S	Vanes (set of 4)
8	9000-25 Hex Nipple	25	9000-09 Galvanized Cross	Model A-750, A-750TE Service Kit (Not Shown)	
9	9700-79 Pressure Relief Valve	26	9000-07 Chrome Hex Bushing	9700-50	Service Kit Includes; Vanes (set of 4), Filters, and Flushing Liquid
10	9600-26 Brass Tee	27	9700-09 Exhaust Filter Assembly (w/Filter)	9700-51S	Vanes (set of 4)
11	9700-10 Exhaust Filter Ass. (w/Filter)	28	9700-05 Carry Handle		
12	9000-27 Reducer (Optional)	29	9700-15 Exhaust Filter Canister		
13	9700-03 Pressure Relief Valve	30	9700-15 Coupler (See page 35)		
14	9512-02 Cord 6.5 w/Switch				